



Secondary Catch



The 91-300 series is a compact, adjustable-grip Tension Latch offering high strength. The latches provide for gasket pull-up and are vibration-resistant. Stainless steel versions are available. The secondary lock is extremely rugged, and must be manually operated before the draw hook can be disengaged from the keeper. The 91-300 Series can be combined with either of two keepers for greater adjustability.

Material & Finish

Material: Cold rolled steel
Finish: Zinc plate with chromate
Option: 300 series stainless steel or equivalent

Mechanical

Ultimate Strength: 326 lbs.
Working Strength: 270 lbs. (stainless steel model, 160 lbs.)
Pull-up Ability: 0.31"
Adjustability: 0.31"
Installation: Latches and keepers may be secured with either #3 unified round head screws, #3 round head wood screws, or 2.5 mm round head rivets.

Caution: Handle leverage can damage latch if link is set too short.

All dimensions on this page are in inches.

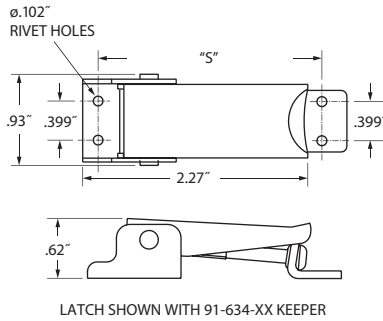

LATCH SHOWN WITH 91-634-XX KEEPER

Secondary Lock

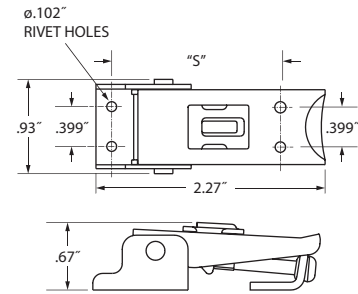

LATCH SHOWN WITH 91-631-XX KEEPER

Note: Draw latch and Keepers ordered separately.

91-300 Series Part Numbers

	Concealed Base	Exposed Base
Rod Style, Steel, Zinc plate	91-311-07	91-351-07
Rod Style, Stainless Steel, Bright	91-311-52	91-351-52
Rod Style, Secondary Catch Steel, Zinc plate	91-321-07	91-361-07
Rod Style, Secondary Catch Stainless Steel, Bright	91-321-52	91-361-52

Keepers



91-634

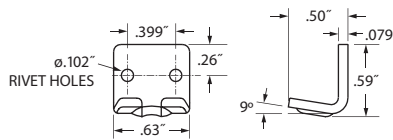

Adjustability Range

"S"	Part Numbers	
	Cold Rolled Steel	Stainless Steel
2.54" to 2.85"	91-634-07	91-634-52
1.53" to 1.85"	91-631-07	91-631-52

91-631

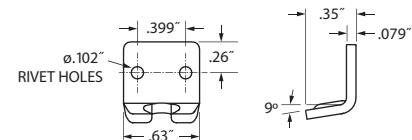

Southco® 91 Draw Latch Under-Center, Adjustable Grip

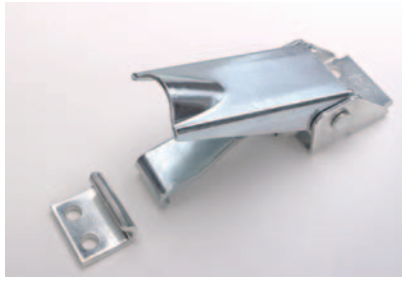

- Optional padlock hasp
- Supplied with strike

These adjustable tension latches provide the strength to keep heavy containers secured. The 91-700 Series is an under-center design for large take-up and are made of cold rolled steel or corrosion resistant stainless steel. A matching keeper is supplied with each.

Material & Finish

Material: Cold rolled steel
Finish: Zinc plate
Option: Stainless steel

Mechanical

Ultimate Strength: 800 lbs.
Working Strength: 600 lbs.
Pull-up Ability: .38
Adjustability: ± 0.23 " (or .46)

91-700 – Medium Duty

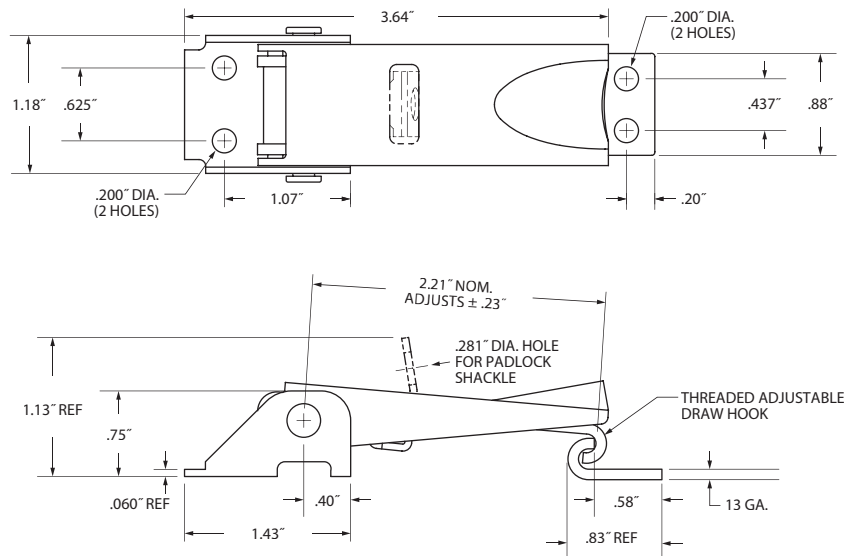

91-700 series Part Numbers:

	Steel, zinc plate	Stainless Steel
Standard Latch	91-752-07	91-752-52
Padlock Hasp	91-772-07	91-772-52

Draw Latches

All dimensions on this page are in inches.

Southco® 91 Draw Latch Under-Center, Adjustable Grip

southco®



The 91-700 Series is a rugged adjustable grip Draw Latch. Its grip length and locking tension can easily be changed without a tool at any time.

Material & Finish

Material: Cold rolled steel
Finish: Zinc plate with chromate
Option: Stainless steel

Mechanical

Ultimate Strength Mild Steel: 800 lbs.
Ultimate Strength Stainless Steel: 675 lbs.
Working Strength Mild Steel: 600 lbs.
Working Strength Stainless Steel: 450 lbs.
Pull-up Ability: 0.200"

Caution: Handle leverage can damage latch if link is set too short. Once latch reaches rated load, every turn-in of link adds about 50 lbs. to locked preload, with little change in locking force.

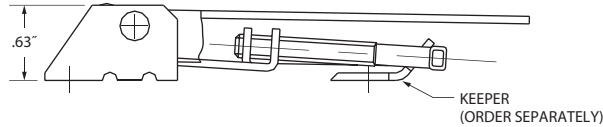
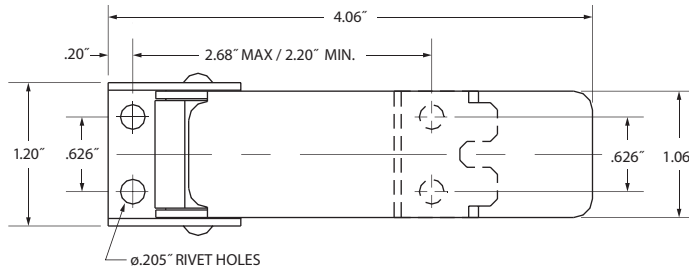

Note: Draw latch and Keeper ordered separately.

91-700 Series Part Numbers

Steel, Zinc plate	91-751-07
Stainless Steel, Bright	91-751-52

Keeper

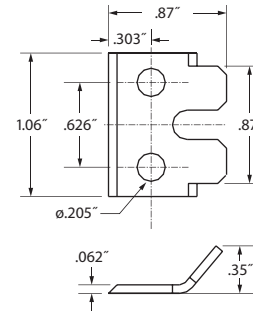

Material	Part Number
Cold Rolled Steel	91-674-07
Stainless Steel	91-674-52

All dimensions on this page are in inches.

Draw Latches

Southco® 91 Draw Latch Under-Center, Stainless Steel

southco®



Working Load 800 lbs.

- Optional padlock hasp
- Supplied with keeper

91-800 Series latches are designed for heavy duty service. The adjustable link has a range of 2.6 to 3.9 inches. For extra security, latch mounting holes are positioned below, and covered by, the latch handle, as is the under-center link. An optional padlock hasp is also available.

Material & Finish

Material: Stainless steel
Finish: Passivated

Mechanical

Ultimate Strength: 1000 lbs.
Working Strength: 800 lbs.
Pull-up Ability: .56
Adjustability: 0.70"
Weight: .5 lbs.

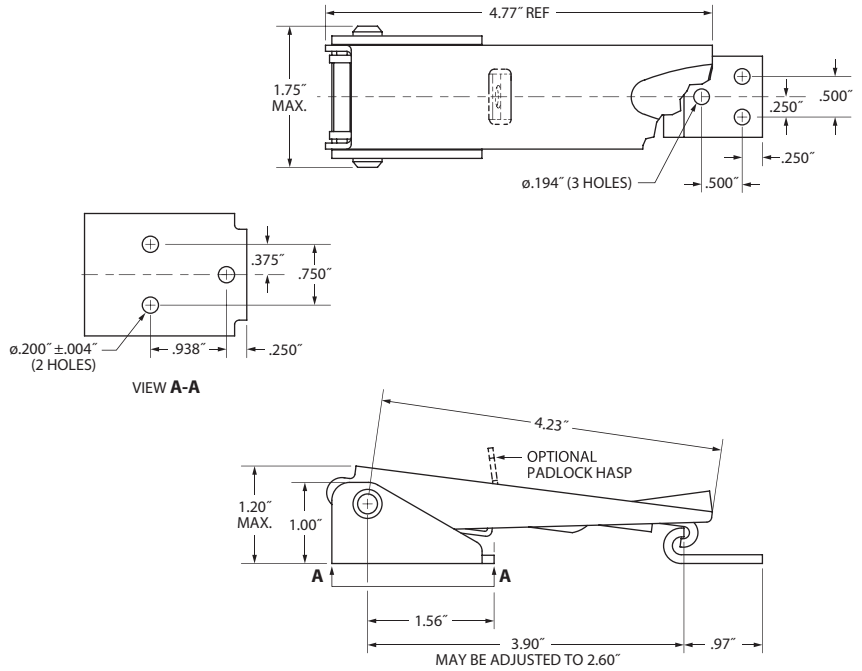

Draw Latches

91-800 Series Part Numbers:

	Stainless Steel
Standard Latch	91-812-52
Padlock Hasp	91-832-52

All dimensions on this page are in inches.

Southco® Draw Latches

Under-center Series

- For applications where latching can occur out-of-plane
- Kickout feature moves unlatched hook from keeper
- Adjustable
- Padlock and secondary catch options
- Stainless or plated steel in bright or black finish

Latch - Secondary Catch option

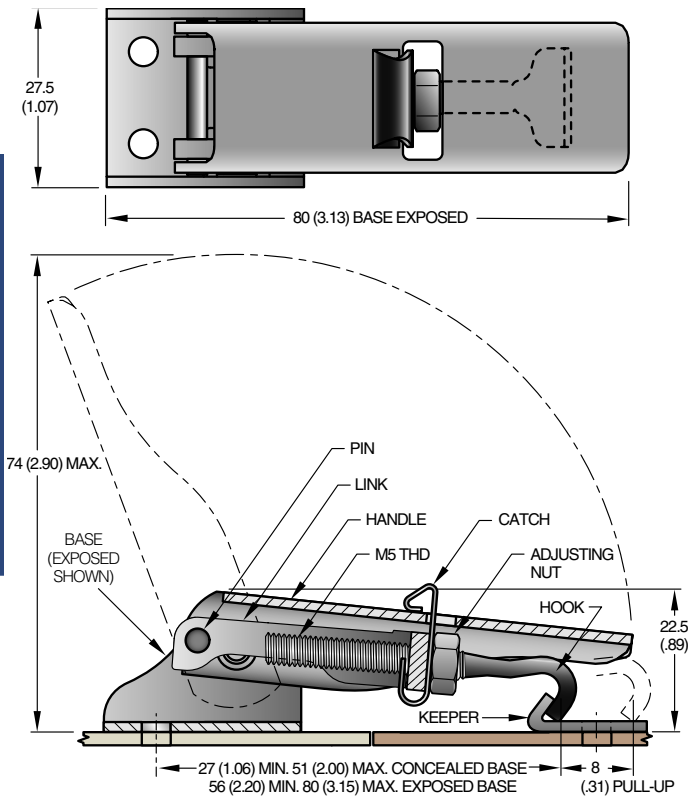

Latch - Hasp option

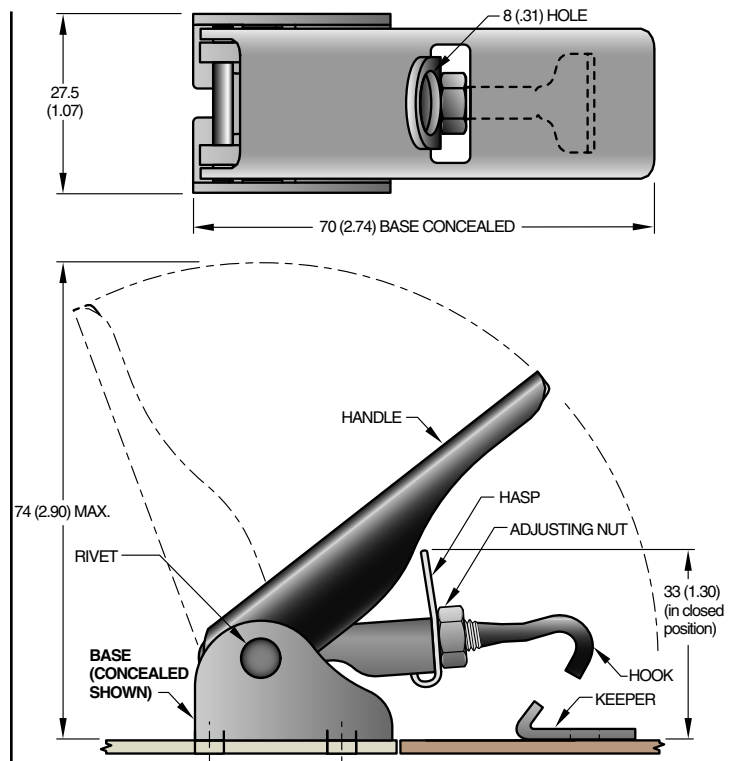

Keepers

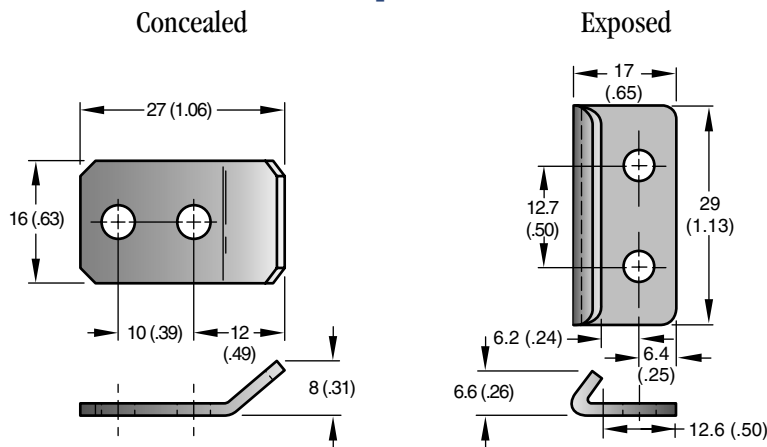

Draw Latches
Steel/Stainless Steel

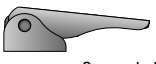
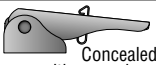
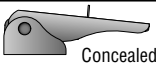
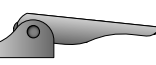
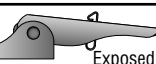
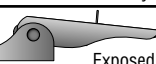
Style	Finish	LATCH PART NUMBERS
 Concealed base	Steel, zinc plate	91-512-07 •
	Stainless steel, black	91-512-25 •
	Stainless steel, bright	91-512-52 •
 Concealed base with secondary catch	Steel, zinc plate	91-522-07 •
	Stainless steel, bright	91-522-52 •
 Concealed base with padlock hasp	Steel, zinc plate	91-532-07 •
	Stainless steel, bright	91-532-52 •
 Exposed base	Steel, zinc plate	91-552-07 •
	Stainless steel, black	91-552-25 •
	Stainless steel, bright	91-552-52 •
 Exposed base with secondary catch	Steel, zinc plate	91-562-07 •
	Stainless steel, bright	91-562-52 •
 Exposed base with padlock hasp	Steel, zinc plate	91-572-07 •
	Stainless steel, bright	91-572-52 •



Finish	KEEPER PART NUMBERS	
	(Concealed)	(Exposed)
steel, zinc plate	91-600-07 •	K4-2338-07 •
stainless steel, bright	91-600-52 •	K4-2338-52 •
stainless steel, black	91-600-63 •	K4-2338-63 •

Draw Latches
Steel/Stainless Steel

Panel Preparation

Exposed base latch - Concealed keeper

Concealed base latch - Concealed keeper

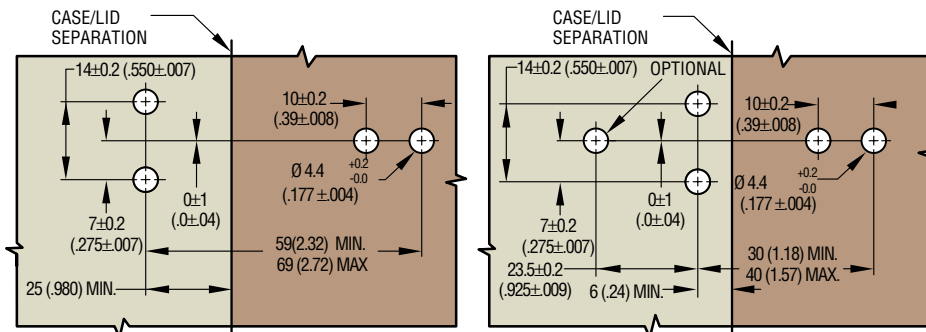

Exposed base latch - Exposed keeper

Concealed base latch - Exposed keeper

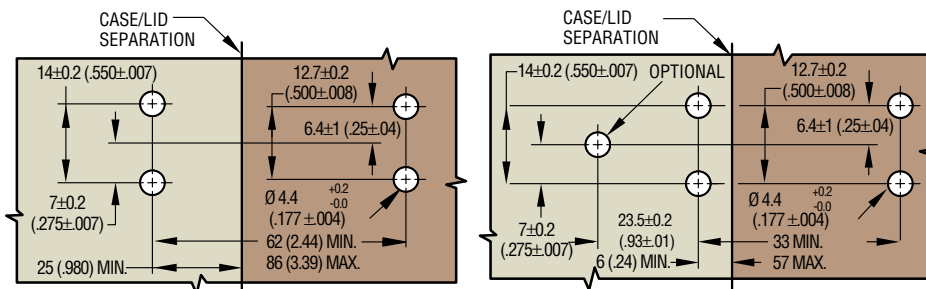

Material and Finish

BASE, HANDLE and LINK: 1008 Steel, zinc plated plus bright chromate dip or 304 stainless steel, passivated, or black powder coated.

KEEPER: 1008 Steel, zinc plated plus bright chromate dip or 304 stainless steel, bright or black oxide.

PADLOCK HASP: 304 Stainless steel, passivated.

HOOK and NUT: 1008 Steel, zinc plated plus bright chromate dip or 304 stainless steel, passivated, or black oxide.

RIVET and PIN: 302 Stainless steel, passivated, or black powder coated.

SECONDARY CATCH: 17-7 PH Stainless steel, passivated.

Installation

1. Use M4 or No. 8 hardware for mounting.
NOTE: Maximum head height for mounting hardware on optional hole of concealed base is 2.5 mm (.098 in.).
2. Adjust HOOK to provide desired compression when latched.
3. While securely holding HOOK, tighten ADJUSTING NUT with wrench.

millimeter (inch)
millimeter (inch)

Dimensions without tolerances are for reference only.