

Southco® Draw Latches

Adjustable Series, Large Size

- Heavy gauge steel
- Hooked latching rod adjusts to fit your grip range
- Low profile design with large vinyl-covered handle

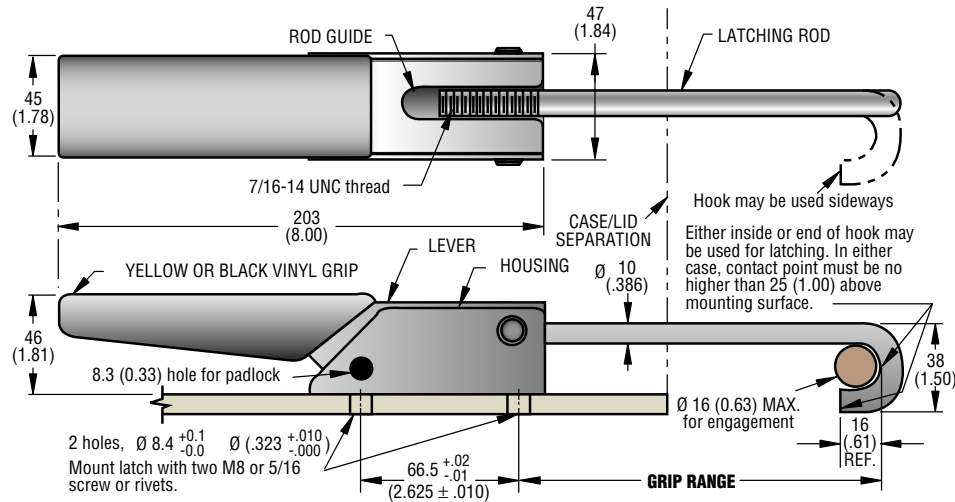

GRIP RANGE		PART NUMBERS	
MIN.	MAX.	Bright latch with yellow vinyl grip	Black latch with black vinyl grip
89 (3.50)	114 (4.50)	A1-11-902-20 •	A1-11-902-31 •

To adjust

1. With lever in latched position turn latching rod until desired tension is reached.

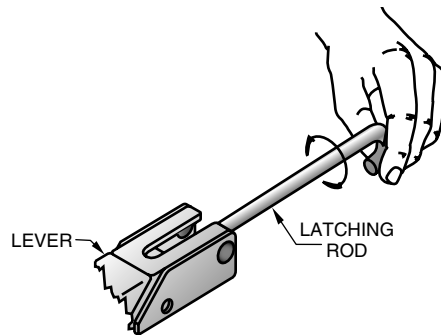

2. Raise lever and tighten jam nut hard against rod guide using a box-end wrench. Hold latching rod to prevent rotation.

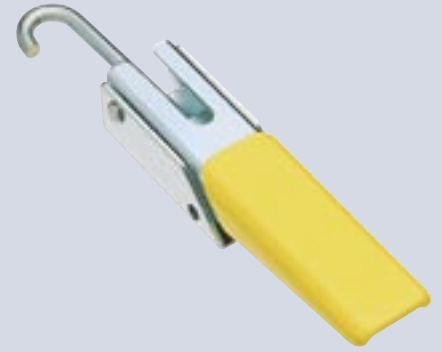
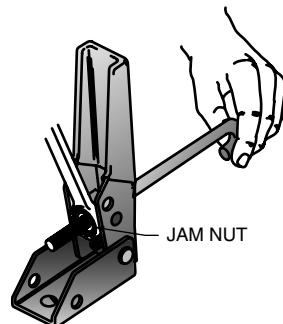

Material and Finish

Bright latch with yellow vinyl grip:

LEVER, HOUSING and ROD: 1010 Steel, zinc plated plus bright chromate dip. JAM NUT, RIVET and PIN: Low carbon steel, zinc plated plus bright chromate dip.

ROD GUIDE: 12L14 Steel, zinc plated plus bright chromate dip.

Black latch with yellow or black vinyl grip:

LEVER, HOUSING: 1010 Steel, black powder coated.

JAM NUT: Low carbon steel, zinc plated plus chromate dip.

RIVET and PIN: Low carbon steel, zinc immersion coating.

ROD and GUIDE: 12L14 Steel, zinc plated plus black organic coating.

Product Strength Guidelines

(To assist in your product selection; samples are available for your evaluation.)

Latched at end of hook:

Maximum static load: 2225 N (500 lbs.)

Average ultimate load: 3110 N (700 lbs.)

Latched at center of radius:

Maximum static load: 4450 N (1000 lbs.)

Average ultimate load: 6670 N (1500 lbs.)

millimeter (inch)
millimeter
(inch)

Dimensions without tolerances are for reference only.

Southco® Draw Latches

Adjustable Series, Small and Medium Sizes

- Ball-end Latching Rod
- Latching rod adjusts to fit your grip range
- Steel or Stainless steel available

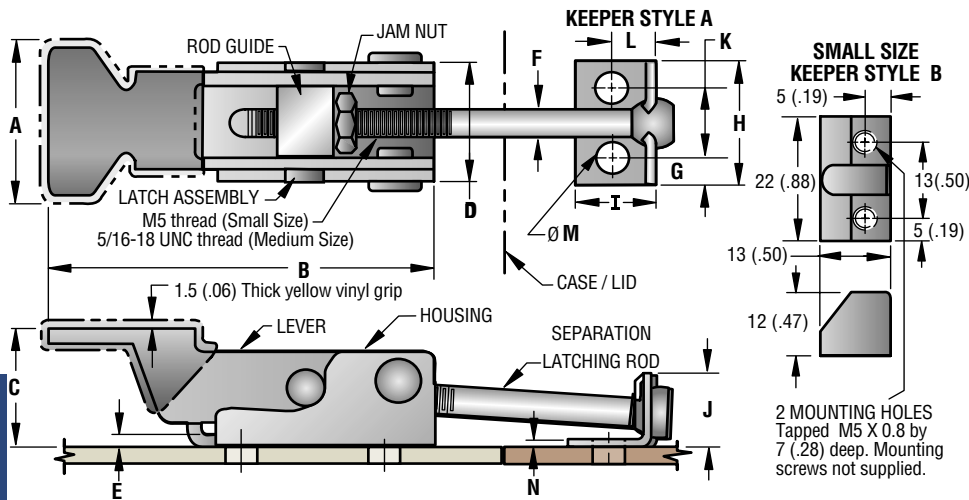

SIZE	DIMENSIONS													
	A	B	C	D	E	F	G	H	I	J	K	L	M	N
Small	27 (1.06)	68 (2.66)	20 (.78)	21 (.82)	1.6 (.060)	4.4 (.17)	5 (.19)	22 (.88)	14 (.56)	11 (.44)	13 (.50)	8 (.31)	5.2 (.203)	1.3 (.050)
Medium	40 (1.56)	113 (4.45)	32 (1.25)	31 (1.21)	1.9 (.075)	7 (.27)	6 (.25)	31 (1.21)	19 (.75)	19 (.75)	19 (.75)	11 (.44)	6.7 (.265)	1.5 (.060)



KEEPER STYLE	PART NUMBERS	
	Steel, zinc plated	Stainless steel, passivated
Small Size without yellow vinyl grip		
A	A1-10-501-10 •	A1-10-501-40 •
B	A1-10-503-10 •	—
Small Size with yellow vinyl grip		
A	A1-10-501-20 •	A1-10-501-50 •
B	A1-10-503-20 •	—
Medium Size without yellow vinyl grip		
A	A1-10-701-10 •	A1-10-701-40 •
Medium Size with yellow vinyl grip		
A	A1-10-701-20 •	A1-10-701-50 •

Material and Finish

Steel Version

(Keeper Style A)

LEVER and HOUSING: 1010 Steel.

ROD GUIDE and JAM NUT: Low carbon steel.

ROD (Medium Latch): 1008 Steel. ROD

(Small Latch): 1006 Steel. KEEPER STYLE A: 1064 Steel. Steel components are zinc plated plus bright chromate dip.

KEEPER STYLE B: Die-cast zinc with chemical protective film.

RIVET: 302 Stainless steel, passivated.

Stainless Steel Version

(Keeper Style A)

LEVER and HOUSING: 304 Stainless steel, passivated.

ROD and RIVET: 302 Stainless steel, passivated.

ROD GUIDE, JAM NUT: 300 Stainless steel, passivated.

KEEPER: 17-7PH Stainless steel, passivated.

Product Strength Guidelines

(To assist in your product selection; samples are available for your evaluation.)

Small Size

(Keeper Style A Only)

Maximum static load: 180 N (40 lbs.)

Average ultimate load: 330 N (75 lbs.)

Small Size (Keeper Style B)

Maximum static load: 1550 N (350 lbs.)

Average ultimate load: 2180 N (490 lbs.)

Medium Size (Keeper Style A)

Maximum static load: 890 N (200 lbs.)

Average ultimate load: 1780 N (400 lbs.)

millimeter (inch)

millimeter
(inch)

Dimensions without tolerances are for reference only.

Installation

Prepare case and lid as shown and mount both latch and keeper using four screws or rivets.

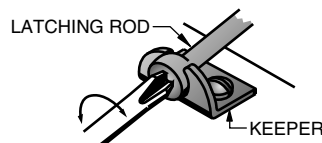
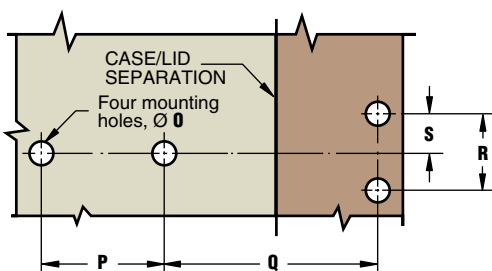

To Adjust:

1. With rod and lever in latched position, turn latching rod with a Phillips screwdriver until desired tension is reached.
2. Raise lever and tighten jam nut hard against rod guide using an open end wrench. Use Phillips screwdriver to prevent latching rod from turning.

SIZE	INSTALLATION DIMENSIONS					
	Ø Ø +0.2 (+.010) -0.0 (-.000)	P +0.1 (+.005) -0.2 (-.010)	Q		R ±0.2 (.005)	S ±0.2 (.005)
			MIN.	MAX.		
Latch with keeper style A						
Small	5.2 (.203)	25.5 (1.000)	25 (1.00)	44 (1.75)	12.7 (.500)	6.4 (.250)
Medium	6.7 (.257)	44.5 (1.750)	24 (.94)	57 (2.25)	19 (.750)	9.5 (.375)
Latch with keeper style B						
Small	5.2 (.203)	25.5 (1.000)	29 (1.13)	48 (1.88)	12.7 (.500)	6.4 (.250)

Southco® Draw Latches

Adjustable Series, Small and Medium Sizes

- Hooked Latching Rod
- Latching arm adjusts to fit your grip range
- Steel or Stainless Steel available

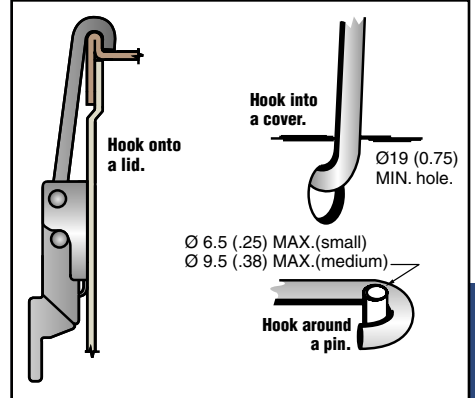
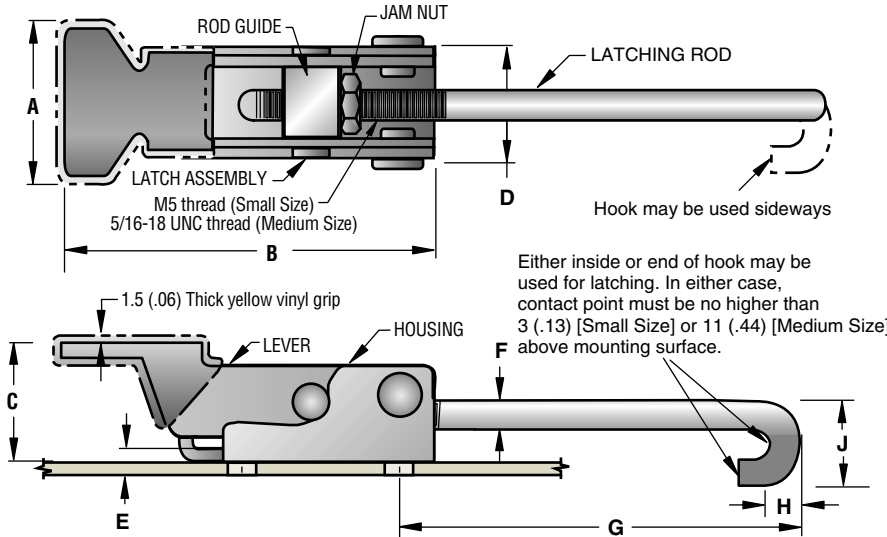
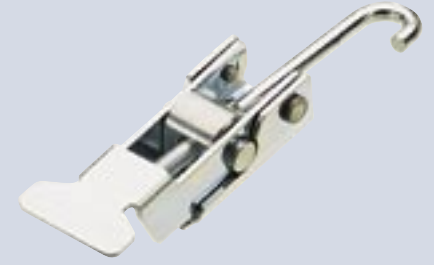

SIZE	DIMENSIONS									
	A	B	C	D	E	F	G MIN.	G MAX.	H REF.	J
Small	27 (1.06)	68 (2.66)	20 (.78)	21 (.82)	1.6 (.060)	4.4 (.17)	39 (1.5)	59 (2.3)	6 (.24)	17 (.67)
Medium	40 (1.56)	113 (4.45)	32 (1.25)	31 (1.21)	1.9 (.075)	7 (.27)	79 (3.13)	113 (4.44)	9 (.36)	25 (1.00)

PART NUMBERS	
Steel, zinc plated	Stainless steel, passivated
Small Size without yellow vinyl grip	
A1-11-502-10 •	A1-11-502-40 •
Small Size with yellow vinyl grip	
A1-11-502-20 •	A1-11-502-50 •
Medium Size without yellow vinyl grip	
	A1-11-702-40 •
Medium Size with yellow vinyl grip	
A1-11-702-20 •	A1-11-702-50 •

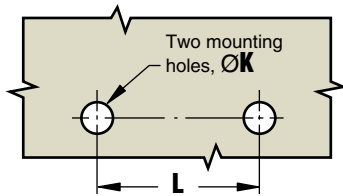

INSTALLATION DIMENSIONS	
$\text{ØK} \begin{smallmatrix} \pm 0.1 \\ (\pm 0.05) \end{smallmatrix}$	$L \begin{smallmatrix} \pm 0.2 \\ (\pm 0.10) \end{smallmatrix}$
Small Size	
5.3 (.209)	25.5 (1.00)
Medium Size	
6.5 (.257)	44.5 (1.750)

Material and Finish

Steel Version

LEVER and HOUSING: 1010 Steel. ROD GUIDE and JAM NUT: Low carbon steel. ROD: 1008 Steel. ALL STEEL PARTS are zinc plated plus bright chromate dip. RIVET: 302 Stainless steel, passivated. GRIP: Vinyl, yellow.

Stainless Steel Version

LEVER and HOUSING: 304 Stainless steel. ROD GUIDE: 303 Stainless steel. JAM NUT: 300 Stainless steel. ROD and RIVET: 300 Series Stainless steel. ALL STAINLESS STEEL PARTS are passivated. Available with or without yellow vinyl grip.

Product Strength Guidelines

(To assist in your product selection; samples are available for your evaluation.)

Latched at end of hook	Small	Medium
Maximum static load	1200 N (270 lbs.)	1780 N (400 lbs.)
Average ultimate load	1800 N (400 lbs.)	2270 N (510 lbs.)
Latched at center of radius	Small	Medium
Maximum static load	1350 N (300 lbs.)	3110 N (700 lbs.)
Average ultimate load	1700 N (380 lbs.)	4900 N (1100 lbs.)

Dimensions without tolerances are for reference only.

To adjust

1. With lever in latched position, turn latching rod until desired tension is reached.
2. Raise lever. While holding latching rod to prevent rotation, tighten jam nut hard against rod guide using an open end wrench.

